

Schoolhouse Welcome

Schoolhouse Facts

1. As early as 1647 law in Massachusetts decreed that any town of 50 or more families had to establish an elementary school.
2. This was the first law requiring compulsory education in the western world.
3. One of the first books used in school was the "horn book". It was a wooden paddle to which pages were attached then covered with very thin, translucent animal horn.

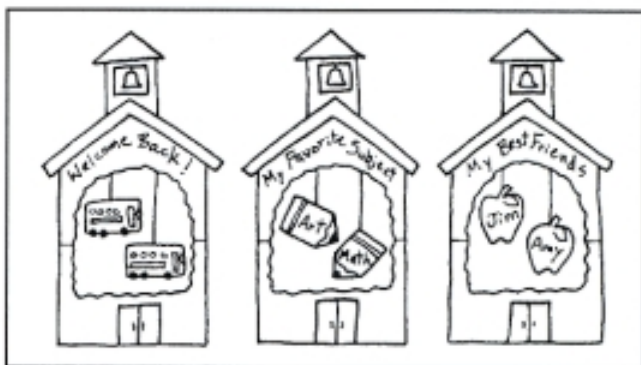

front

Schoolhouse Welcome Standing Mobile

Great for "Back To School Night"

Materials for each child:

- 3 schoolhouse tops (page 7) copied on red construction paper
- 3 schoolhouse bottoms (page 8) copied on red construction paper
- assorted pencils, books, computers, etc. (page 10) copied on white paper
- 6 pieces of yarn, approximately six inches long
- access to one sided tape
- access to a stapler

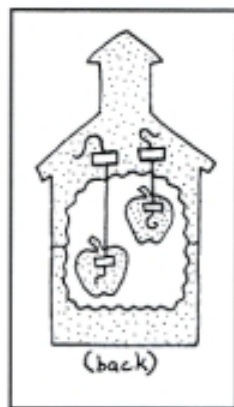

finished project

1. Cut out all schoolhouse tops and bottoms.
2. Glue tops to bottoms using glue tabs as shown.
3. Instruct the student to choose six items to hang in the mobile. Color and cut them out.
4. Poke a hole in the middle of each large schoolhouse and cut out a large space between the roof line and the door. Under the roof line of each schoolhouse write the theme for the items that will hang in the space. Examples can include Welcome Back!, My Favorite Subjects, My Best Friends, My Favorite Sports, My Favorite Computer Games or Website, My Favorite Author or Book Titles, etc.
5. Instruct the student to choose two small patterns for each space in the schoolhouses and write the appropriate words on small patterns. For example; if the student has written Welcome Back under the roof line, he may want to choose two busses and write his teachers name on one bus and the school name or room number on the other bus.
6. Lay one large schoolhouse face down on the desk. Place the two smaller patterns face down on the desk in the cut out space. Place a piece of yarn so it connects each small pattern to the large pattern, near the top. Secure each end of the yarn with a piece of tape as shown. Repeat for the two remaining large schoolhouses.
7. Place two of the large schoolhouses back to back and staple ONE edge. Open the two pieces (like a book) and staple the remaining schoolhouse to the edges of the first two pieces as shown. The three schoolhouses should stand with the small patterns dangling in the center of each piece. For extra sturdiness, lightly crease each edge towards the staples.

☞ Place on each child's desk for back to school night.

Option: Take a snapshot of each child on the first day of school and use it in the mobile instead of one of the small patterns.

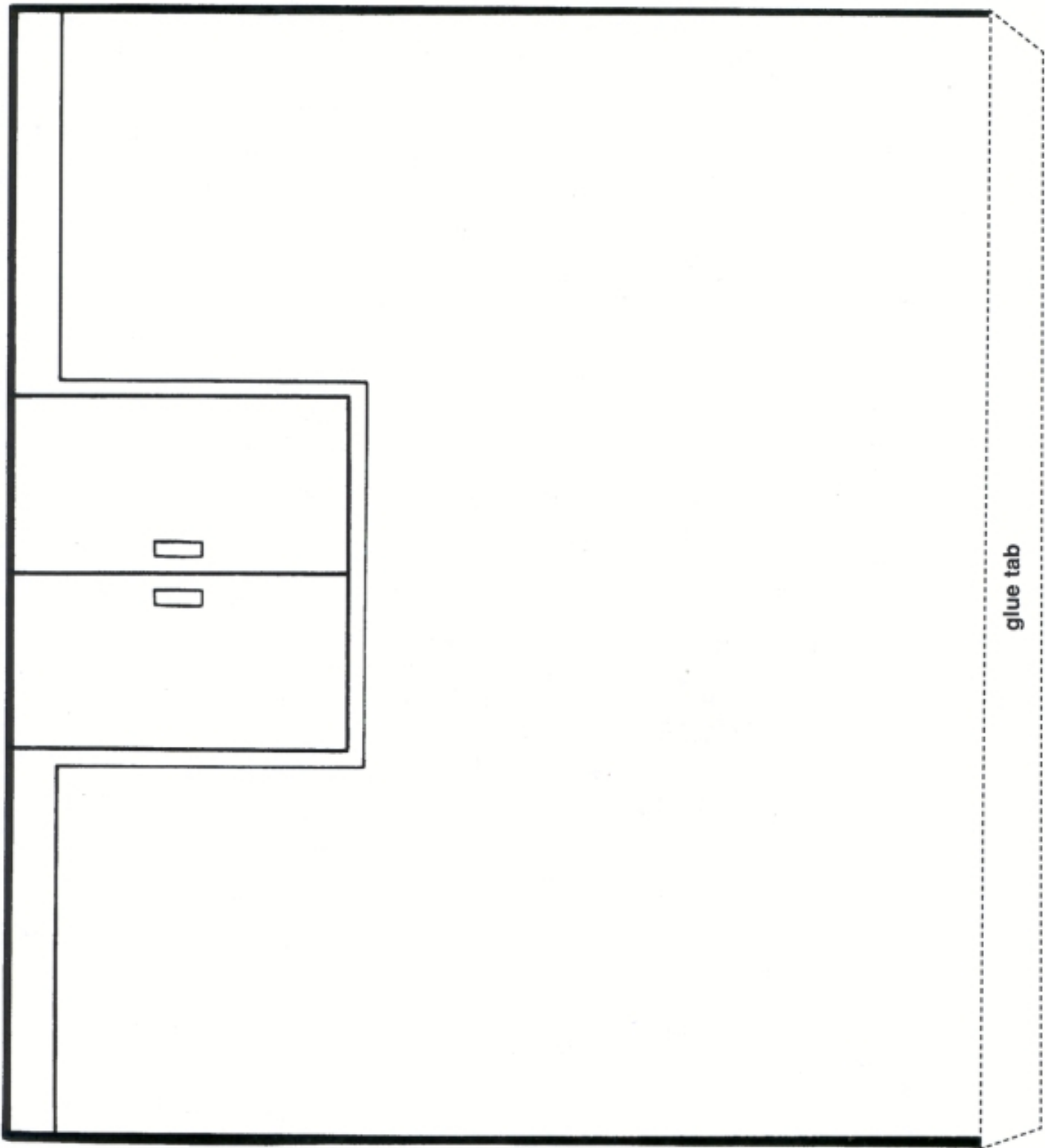

glue tab

